



Round quick-changers Ø 50 mm, 6 air inlets – gripper side



Product notes

- > Manual interface between robot and gripper system
- > Air connections always correctly aligned
- > Body made of anodized aluminum alloy

Technical data

Item no.	SR50-B
Lifting force [N]	200
Number of pneumatic connections	6xM5
Working pressure [bar (psi)]	0 - 6 (0 - 87)
Max. torque [Nm]	50
Max. bending moment [Nm]	30
Weight [g]	69
Suitable electrical connectors	20.538

Dimensions

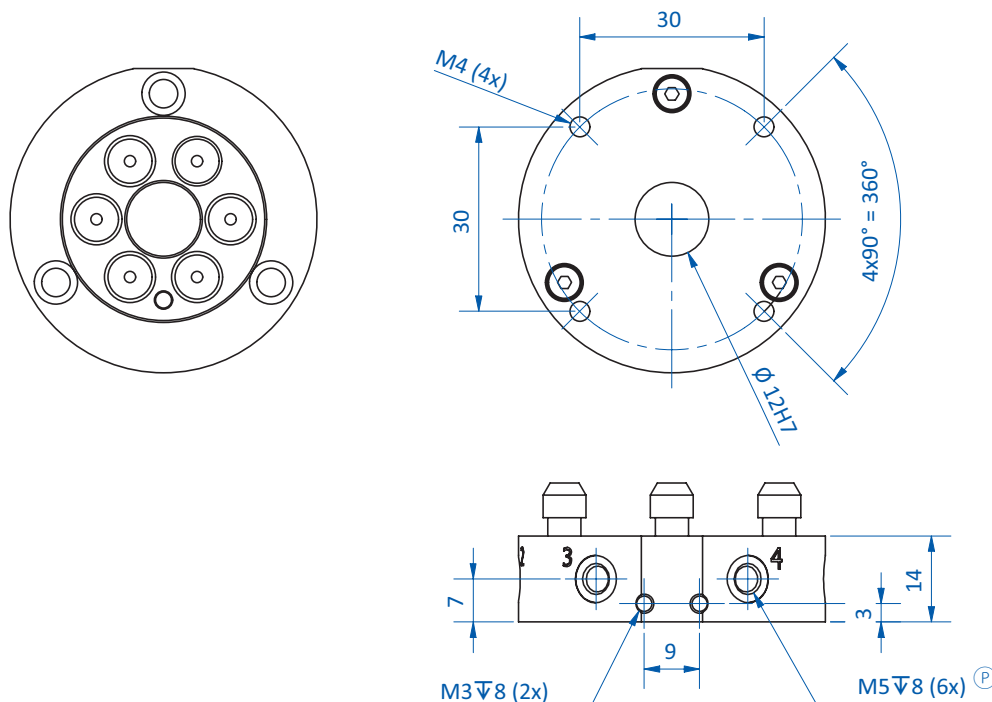

Ⓟ = Pneumatic connection