



Series | Bellows vacuum cups SB

High-temperature Thermalon®-flocked bellows cups, 1.5 folds – SKT-B1

High-temperature Thermalon®-flocked bellows cups, 1.5 folds – SKT-B1



Product notes

Bellows vacuum cup made of proven Thermalon® with additional patented flock coating of the contact surfaces for the highest demands on non-marking gripping.

Ideally suited for uneven surfaces with special suitability for the removal of hot plastic parts to be painted from the injection molding machine.

Thermalon® is a material mixture with a hardness of 60° Shore A, specially optimized for the plastics industry.

Flock coating made of thin polyamide layer PA6.6 black. Connection by means of plug nipple.

Advantage

- > Nearly non-marking
- > Quick depositing of the product, as there is no static friction due to thin flock coating
- > Free of silicone and other paint-wetting-impairment substances (PWIS)
- > Bellows compensates for height differences and allows good adaptation to curved or uneven product surfaces
- > Temperature-resistant up to 160 °C (320 °F)

Notes:

The flock coating could cause leakage, which must be taken into account in the layout of the vacuum source.

Technical data

Item no.	Model		Number of folds	Material / Color	Required suction power for 60 % vacuum [NI/min]	Short-term working temperature < 30 Sec [°C (°F)]
23.005.286.19F	SKT-B1-6	2	1.5	Thermalon®-flocked (bl/sw)	7	0 - 160 (32 - 320)
23.011.234.19F	SKT-B1-11	5.5	1.5	Thermalon®-flocked (bl/sw)	11	0 - 160 (32 - 320)
23.014.235.19F	SKT-B1-14	5	1.5	Thermalon®-flocked (bl/sw)	16	0 - 160 (32 - 320)
23.016.236.19F	SKT-B1-16	8.5	1.5	Thermalon®-flocked (bl/sw)	16	0 - 160 (32 - 320)
23.020.238.19F	SKT-B1-20	5	1.5	Thermalon®-flocked (bl/sw)	17	0 - 160 (32 - 320)
23.022.239.19F	SKT-B1-22	8	1.5	Thermalon®-flocked (bl/sw)	17	0 - 160 (32 - 320)
23.025.240.19F	SKT-B1-25	12	1.5	Thermalon®-flocked (bl/sw)	18	0 - 160 (32 - 320)
23.033.241.19F	SKT-B1-33	11	1.5	Thermalon®-flocked (bl/sw)	18	0 - 160 (32 - 320)

Accessories

Item no.	 Suitable fittings						
	M5-male	M5-female	M6-male	G1/8-male	G1/8-female	G1/4-male	G1/4-female
23.005.286.19F	270.772	--	--	--	--	--	--
23.011.234.19F	270.772	270.347	270.104	270.033	270.478	--	--
23.014.235.19F	270.772	270.347	270.104	270.033	270.478	--	--
23.016.236.19F	270.772	270.347	270.104	270.033	270.478	--	--
23.020.238.19F	270.772	270.347	270.104	270.033	270.478	--	--
23.022.239.19F	270.772	270.347	270.104	270.033	270.478	--	--
23.025.240.19F	270.772	270.347	270.104	270.033	270.478	--	--
23.033.241.19F	--	--	270.315	270.196	270.114	270.190	270.192



Dimensions

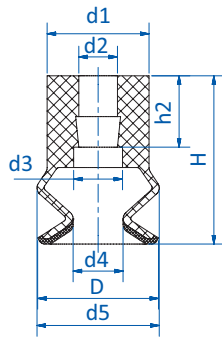

Drawing A

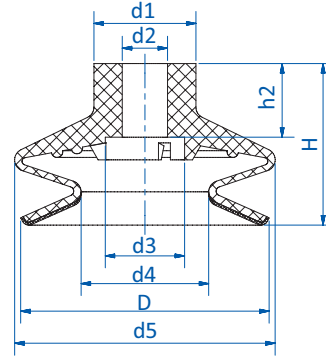

Drawing B

Item no.	Drawing	Ø D [mm]	Ø d1 [mm]	Ø d2 [mm]	Ø d3 [mm]	Ø d4 [mm]	Ø d5 [mm]	H [mm]	h2 [mm]
23.005.286.19F	A	6	7	3.8	--	2.5	6.4	11.5	7
23.011.234.19F	A	11.9	10	3.8	4.8	4.9	12	16.5	7
23.014.235.19F	A	14.9	10	3.8	4.8	4.8	14	16.5	7
23.016.236.19F	A	16.8	10	3.8	4.8	8.2	17.5	19.5	7
23.020.238.19F	A	19.9	10	3.8	4.8	10.6	20	16.5	7
23.022.239.19F	A	22.9	10	3.8	4.8	11.4	24	19.5	7
23.025.240.19F	A	24.9	10	3.8	4.8	9.2	25	23.5	7
23.033.241.19F	B	33.9	18	8	16	17	36	28	13